

Sunset Beach Resort

[Phase One]

by: **Prairie's Edge Development Corporation**

Stage 2 = 23 Lots

[Page 3 of 3]

PLAN SHOWING PROPOSED SURFACE SUBDIVISION

of part of Parcel B, Plan No. 102213548

in L.S.D. 7, 8 and 9

SEC. 27

TWP. 25 RGE. 6 W.3 M.

R.M. of Loreburn No. 254

SASKATCHEWAN

Scale 1:2000

2017 - 2018

Parcel B, Plan No. 102213548

[Future Subdivision]

SUNSET BEACH ROAD
(Road Allowance)

MB3
MUNICIPAL BUFFER

ROAD WIDENING
(See Detail)
(in Page 1 of 3)

MB2
MUNICIPAL BUFFER

MB1
MUNICIPAL BUFFER

Reg'd Plan No. A B

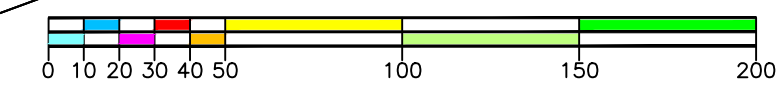

Measurements are in metres and decimals thereof.
Area to be subdivided is outlined in a bold dashed line and contains 1.476± ha. (3.65± Ac.)
Distances on this plan may vary by ±5 m.
Safe Building Elevation 559.37m shown thus
Date of preliminary survey:- May 3rd 2016
Plan revised:- March 29th 2018

Safe Building Elevation
Contour Line
Elevation 559.37m

Saskatchewan Land Surveyor

Owner/Agent

George, Nicholson, Franko, & Associates
Land Surveyors • Global Positioning Systems
Celebrating 108 Years of service to the Province of Saskatchewan
A Division of Meridian Surveys
Saskatoon, Canada

File No. ~ SG15311Areas-Mar14B.dwg
Drawn by: ~Art Mark-March 14th 2018

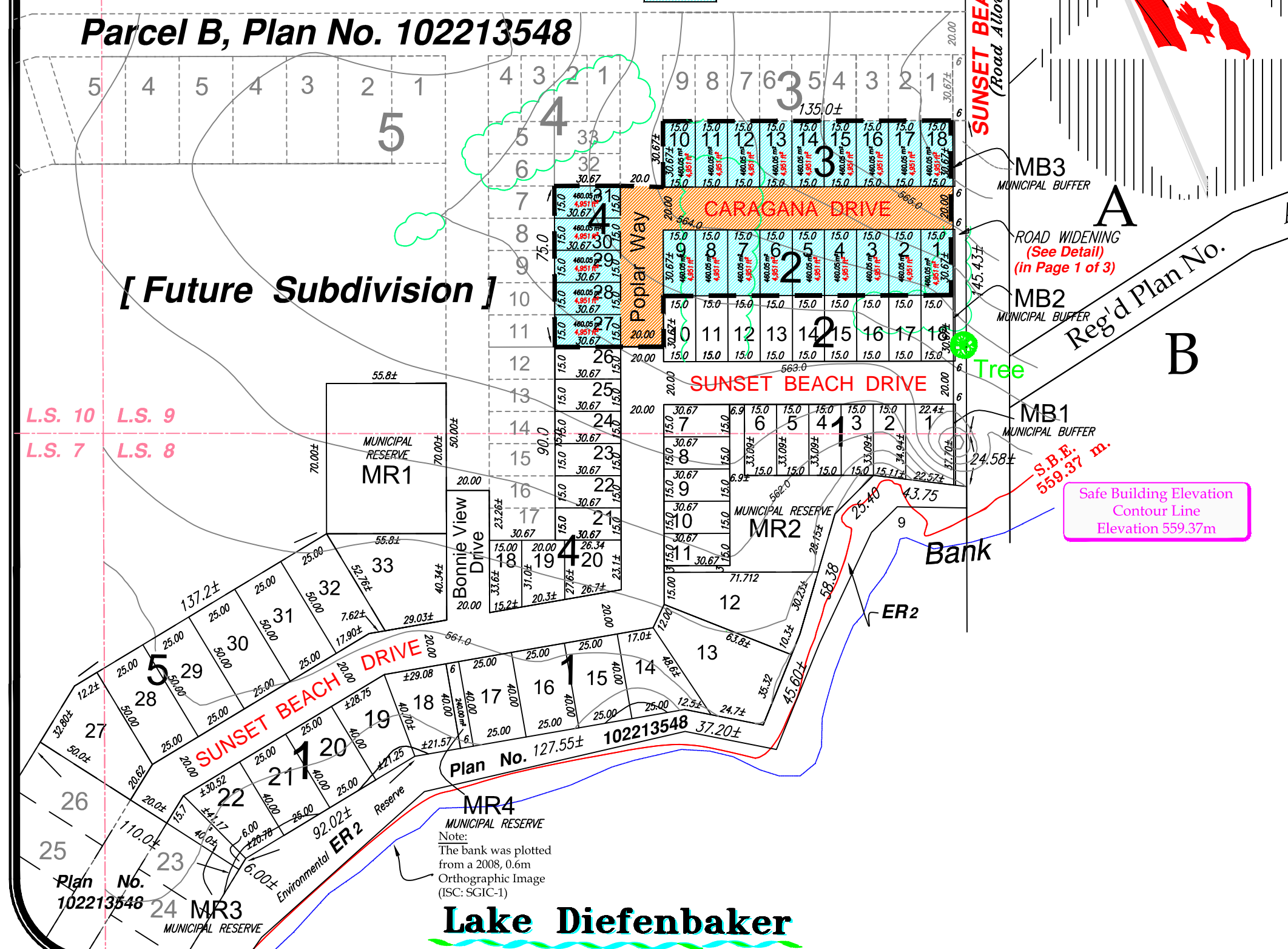

Lake Diefenbaker

MR4
MUNICIPAL RESERVE
Note:
The bank was plotted from a 2008, 0.6m Orthographic Image (ISC: SGIC-1)

L.S. 10 L.S. 9
L.S. 7 L.S. 8

Plan No. 102213548

MR3
MUNICIPAL RESERVE

ER2
Environmental Reserve

Bank

S.B.E. 559.37 m.

Tree

SUNSET BEACH DRIVE

CARAGANA DRIVE

Poplar Way

Bonnie View Drive

MR1
MUNICIPAL RESERVE

SUNSET BEACH DRIVE

Plan No. 127.55±

102213548

MR4

MUNICIPAL RESERVE

Note:

The bank was plotted from a 2008, 0.6m Orthographic Image (ISC: SGIC-1)

Lake Diefenbaker